

IMS Heavy Duty Surge Bins Quote/Ordering Form

Specify:

1. Quantity: _____

2. Capacity:
- | | | | |
|---|--|---|---|
| <input type="checkbox"/> 1,008 lbs / 29 cu ft | <input type="checkbox"/> 4,060 lbs / 116 cu ft | <input type="checkbox"/> 7,196 lbs / 206 cu ft | <input type="checkbox"/> 12,796 lbs / 366 cu ft |
| <input type="checkbox"/> 1,624 lbs / 46 cu ft | <input type="checkbox"/> 4,816 lbs / 138 cu ft | <input type="checkbox"/> 8,008 lbs / 229 cu ft | <input type="checkbox"/> 14,392 lbs / 411 cu ft |
| <input type="checkbox"/> 2,408 lbs / 69 cu ft | <input type="checkbox"/> 5,328 lbs / 161 cu ft | <input type="checkbox"/> 9,604 lbs / 274 cu ft | <input type="checkbox"/> 16,016 lbs / 458 cu ft |
| <input type="checkbox"/> 3,192 lbs / 91 cu ft | <input type="checkbox"/> 6,384 lbs / 182 cu ft | <input type="checkbox"/> 11,200 lbs / 320 cu ft | |

3. Slope Angle: 45° 60°

4. Covers (One piece with 12" x 14" lid door STANDARD):

Hopper Cover (Split 1/3, 2/3 design)

Loader Cut Out for Cover

143879 **\$457.00**

5. Slide Gates:

Rack & Pinion with wheel

143880 **\$890.00**

Manual

143881 **\$399.00**

Gate & Drain (for 45° bins)

143882 **\$526.00**

Gate & Drain (for 60° bins)

143883 **\$526.00**

Gate & Drain (for 45° bins-butterfly)

143884 **\$619.00**

Gate & Drain (for 60° bins-butterfly)

143885 **\$619.00**

6. Distribution Box for vacuum removal:

1 Hole 1.5" 2" 2.5" 3" 4" **\$243**

2 Holes 1.5" 2" 2.5" 3" 4" **\$288**

4 Holes 1.5" 2" 2.5" 3" 4" **\$325**

9 Holes 1.5" 2" 2.5" 3" 4" **\$649**

13 Holes 1.5" 2" 2.5" 3" 4" **\$783**

7. Distribution Box Probe (required for Distribution Box):

1.5" **\$110** 2" **\$118** 2.5" **\$151** 3" **\$205** 4" **\$269**

NOTE: One probe required per distribution box hole

8. Indicator Panel (Number of Bins):

1 **\$900** 2 **\$1,030** 3 **\$1,161** 4 **\$1,290**

9. Paints/Coatings:

Clear epoxy coat inside of hopper (up to 72" x 72") 143891 **\$658.00**

Clear epoxy coat inside of hopper (84" x 84" or more) 143892 **\$885.00**

Paint outside (custom color) 143870 **\$298.00**

10. Misc.

60" Flange to Floor Clearance (20" STD) 143888 **\$585.00**

80" Flange to Floor Clearance (20" STD) 143889 **\$762.00**

Grating inside bin (replaces cover) 143893 **\$837.00**

Hatchway Door Air Filter 143886 **\$108.00**

Additional View Windows (2 standard) 142837 **\$Inquire**

Low Level Indicator (paddle blade style) 147688 **\$396.00**

High Level Indicator (paddle blade style) 147689 **\$396.00**

Level Indicator Flange (extra) 158380 **Inquire**

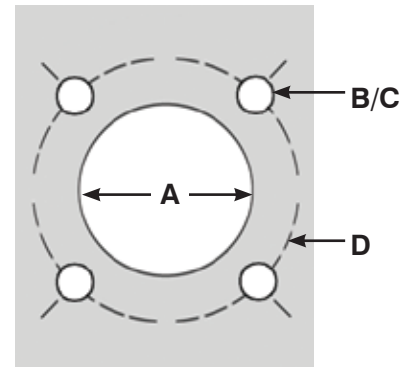

(A) Loader Cut Out Dia:

(B) Mounting Hole Dia:

(C) Number of Mounting Holes:

(D) Mounting Hole Pattern: _____

Date: _____ Quantity: _____ Phone: (_____) _____ Fax: (_____) _____

Name: _____ Title: _____

Company Name: _____ Email: _____

Address: _____

City: _____ State: _____ Zip: _____